

EDGAR COUNTY BOARD

115 W. Court St. Rm. J
Paris, IL 61944-1785
Ph. (217) 466-7433 - Fax: (217) 466-7430
eccr@edgarcountyillinois.com

April 20, 2015

Mr. Steven J. Long, Acting Chief Engineer
Illinois Department of Transportation
Division of Aeronautics
One Langhorne Bond Drive
Abraham Lincoln Capital Airport
Springfield, Illinois 62707-8415

Attn: Mr. Alan Mlacnik, P.E.

RE: Edgar County Airport (PRG)
Relocate Fuel Facility and Expand Apron

Dear Mr. Mlacnik:

Per the recommendation of the Federal Aviation Administration (FAA) and the Illinois Department of Transportation, Division of Aeronautics (IDA), our engineering consultant, Hanson Professional Services Inc., has revisited the justification for the above referenced project and we are providing the enclosed information for your review. We respectfully request your consideration of the attached revised TIP request.

We look forward to IDA and FAA review and concurrence on the proposed project. Please feel free to contact Hanson as necessary to resolve any questions that may arise.

Sincerely,



Ben Jenness
Chairman, Board of Edgar County

Enclosures

Ben H. Jenness, Chairman

Karl E. Farnham, Jr., Vice-Chairman

Alan Zuber

D. Jeffry Voigt

Dan Bruner

Mike Heltsley

Andrew Z. Patrick



LEGEND

<u>PRIORITY</u>	<u>F.Y.</u>	<u>PROJECT DESCRIPTION</u>
1	ANY	ACQUIRE & RELOCATE FUEL TANKS
2	ANY	WEST APRON EXPANSION
3	ANY	EAST APRON EXPANSION

--- EXISTING AIRPORT PROPERTY LINE

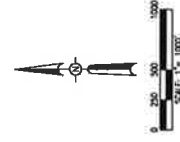

DATE	REVISION

EDGAR COUNTY AIRPORT (PRG)
 EDGAR COUNTY BOARD
 PARIS, EDGAR COUNTY, ILLINOIS
 2016 - 2020 TIPS

HANSON PROJECT	DATE	REVISION
EDGAR COUNTY AIRPORT (PRG)	04/20/2016	1
	04/20/2016	2
	04/20/2016	3
	04/20/2016	4
	04/20/2016	5



PROPOSED AIRFIELD IMPROVEMENTS



Transportation Improvement Program: Airports FFY 2016-2020

Edgar County Airport (PRG)

Sponsor Project Priority	AP Priority Number	Year Requested	Project Title	Project Description	ELEMENTS REQUIRED			JUSTIFICATION				ESTIMATED COST			Notes / Comments	
					Project on ALP Yes / No / NA	Environmental Determination EA / CAT X / EIS	Clear Approaches (Form 6010 Inspection Results)	Land Acquired	Apron Sizing Calcs	RGFE Evaluation Form	Bldg Size Calcs / Equipment Inventory	Federal	State	Local		
					EA (Short Form) Approved 1/28/09	Yes / No	Yes / No / NA	Yes / No / NA	Yes / No / NA	Yes / No / NA	Discretionary / Appointment	Entitlement				
1	17	ANY	Acquire and relocate fuel tanks.	Relocate an existing fuel tank, install a new fuel tank and associated equipment.	EA (Short Form) Approved 1/28/09	Yes	Yes	Yes	N/A	Yes	N/A	\$0	\$312,393	\$0	\$34,735	\$347,325
2	42	ANY	West apron expansion	Expand the apron to the west.	EA (Short Form) Approved 1/28/09	Yes	Yes	Yes	Yes	N/A	N/A	\$380,700	\$148,500	\$28,900	\$29,900	\$596,000
3	42	ANY	East Apron Expansion	Expand the apron to the east.	EA (Short Form) Approved 1/28/09	Yes	Yes	Yes	Yes	N/A	N/A	\$0	\$148,500	\$8,250	\$8,250	\$165,000



Airport:	Edgar County	LOCID:	PRG	Local Priority:	1
Project Description:	Acquire and Relocate Fuel Tanks				FY 2016
Sketch: If not enough space provided below, please attach sketch.					
					
Justification:	See attached IDOT Form "Detailed Project Justification/Description"				
Cost Estimate: (Attach detailed cost estimate)					
Federal (90 %)	\$312,593	State (5 %)	\$0	Local (5 %)	\$34,733
				Total:	\$347,325
Sponsor Verification	Date: (see instruction sheet)				
For each and every project as applicable	6/25/07	Date of approved ALP with project drawn			
	1/28/09	Date of environmental determination (ROD, FONSI, CE) or cite CE paragraph # (307-312) in Order 1050.1E, determination to accompany submittal			
	N/A	Date of land acquisition or signed purchase agreement			
	N/A	Snow removal equipment inventory & sizing worksheet (for SRE acquisition)			
	N/A	Apron sizing worksheet (for apron projects)			
	11/28/12	5010 Inspection Compliance (Attach copy of letter from Bureau of Aviation Safety)			
	Attached	Revenue producing facilities (for fuel farms, hangars, etc.)			

I certify to the best of my belief and knowledge that all runway approaches are clear of obstructions.

Sponsor's Signature: *Ben H. Jenness* Date: 4/20/15
 Printed Name: Ben H. Jenness Title: Chm., Edgar Co. Bd.
 Phone Number: 217-466-7433

Division of Aeronautics use only

Preapp Number	Grant Number	NPIAS Code	Work Code	FAA Priority	Federal \$



Illinois Department of Transportation
Division of Aeronautics

DETAILED PROJECT JUSTIFICATION / DESCRIPTION

AIRPORT NAME: Edgar County Airport

ASSOCIATED CITY: Paris, Illinois

PROJECT TITLE:
Relocate and Upgrade Fuel Facility

PROJECT DESCRIPTION:
Relocate an existing fuel tank, install a new fuel tank and associated equipment

DETAILED PROJECT DESCRIPTION:
See attached letter for project description and justification discussion.



U.S. Department of Transportation

Federal Aviation Administration

Airport Improvement Program

Revenue-Generating Facility Eligibility Evaluation Form

Airports Division
Great Lakes Region

The purpose of this form is to offer guidance to Great Lakes Region Airports District Offices (ADO's) in evaluating the eligibility of a given project or facility for AIP funding under FAA Order 5100.38B, "AIP Handbook," Change 2 issued May 16, 2005, Paragraph 526 (page 72). This form does not replace or supersede any statute or regulation, and it is not required; however, it may help expedite the evaluation by ADO and/or Regional Office staff. In order to make a final determination, the FAA may require further information. Please review instructions before submitting this form and requested attachments.

TO BE COMPLETED BY SPONSOR

Airport and Location	Edgar County Airport (PRG), Paris, IL		
Airport Sponsor	Edgar County Board		
Proposed Project	Upgrade and Relocate Fuel Facility		
Will the Airport Sponsor Own the Facility?	<input checked="" type="checkbox"/> Yes	<input type="checkbox"/> No	
Will the Airport Sponsor Operate the Facility?	<input checked="" type="checkbox"/> Yes	<input type="checkbox"/> No	
If "No," Describe Business Arrangement With Facility Manager	N/A		
Will the Facility be Available for Public Use?	<input checked="" type="checkbox"/> Yes	<input type="checkbox"/> No	
Describe Other Existing, Comparable Facilities, Ownership and Demand	High demand by airport users for additional fuel capacity at the airport.		
Projected Finances	Annual Costs¹	\$45,650 (est.)	Annual Revenues \$57,050 (est.)
Date of Current ALP	6/25/2007	Proposed Project on ALP?	<input checked="" type="checkbox"/> Yes <input type="checkbox"/> No
<i>If proposed project not on current ALP, attach explanation including timeframe for amendment/submission. (REDLINE ALP UPDATE TO BE SUBMITTED AS PART OF PRELIMINARY DESIGN PHASE)</i>			
Lowest Current Pavement Condition Index (PCI) or Equivalent Standard Metric	60 (taxiway)		
All Pavement and NAVAID Project Funding Identified for Next Three (3) Years?	<input checked="" type="checkbox"/> Yes	<input type="checkbox"/> No	
All other Critical Airside Project Funding Identified for Next Three (3) Years?	<input checked="" type="checkbox"/> Yes	<input type="checkbox"/> No	
Date Submitted	April 20, 2015		
Prepared By	Barry Stolz, P.E.	Signature²	
	Aviation Engineer	Telephone	(314) 942-5288
	Hanson Professional Services, on behalf of the Edgar County Board		

Agency Action (to be completed only by FAA or designated state agency)

Disposition	<input type="checkbox"/> Approved	<input type="checkbox"/> Approved conditionally (explain below)	<input type="checkbox"/> Ineligible
Explanation			
Authorized Official			Telephone

¹ Including any ongoing capital costs (e.g., debt service)

² Signature not required if completed form is transmitted via email from the named preparer



Illinois Department of Transportation
Division of Aeronautics

2016 TRANSPORTATION IMPROVEMENT PROGRAM
ESTIMATE OF WORK

Airport Name:	Edgar County Airport		
Associated City:	Paris		
Year Requested:	ANY	Sponsor Priority:	1

PROJECT TITLE:
Acquire and relocate fuel tanks

Estimate of Work							
ITEM	QUANTITY		UNIT PRICE		PRICE	Potential DBE	
	#	Unit(s)	\$	/ Unit		\$	%
EXCAVATION							
Earthwork	100	CY	\$50.00	/ CY	\$5,000.00		
DRAINAGE							
				/			
				/			
				/			
PAVING							
Subbase Preparation	145	SY	\$15.00	/ SY	\$2,175.00		
209	50	TON	\$35.00	/ TON	\$1,750.00		
501	145	SY	\$100.00	/ SY	\$14,500.00		
				/			
				/			
				/			
				/			
				/			
LIGHTING							
Special/ducts	350	LF	\$60.00	/ LF	\$21,000.00		
				/			
				/			
				/			
				/			
LANDSCAPING							
Seeding/Mulching/Blanket	0.25	AC	\$6,000.00	/ AC	\$1,500.00	\$1,500.00	100.00%
Sodding				/			
Watering				/			
Special (Wetlands)				/			
FENCING							
Class C				/			
Class E				/			
Gates (Manual/Electric)				/			
OTHER / MISC.							
Other specialty items	1	LS	\$215,000.00	/ LS	\$215,000.00		
Mobilization				/			
Engineer's Field Office				/			
Haul Route				/			
Erosion Control	1	LS	\$1,000.00	/ LS	\$1,000.00	\$1,000.00	100.00%
Engineering/Contingency/Admin.	1	LS	\$78,900.00	/ LS	\$78,900.00		
Studies (EIS, Drainage, M.P.)	1	LS	\$6,500.00	/ LS	\$6,500.00		
Land Acquisition				/			

TOTAL COST:	Potential DBE	
	\$	%
	\$347,325.00	\$2,500.00 0.72%



Airport:	Edgar County	LOCID:	PRG	Local Priority:	2
Project Description:	Expand Apron to the West				FY 2016
Sketch: If not enough space provided below, please attach sketch.					
					
Justification:	See attached IDOT Form "Detailed Project Justification/Description"				
Cost Estimate: (Attach detailed cost estimate)					
Federal (90 %)	\$538,200	State (5 %)	\$29,900	Local (5 %)	\$29,900
				Total:	\$598,000
Sponsor Verification	Date: (see instruction sheet)				
For each and every project as applicable	6/25/07	Date of approved ALP with project drawn			
	1/28/09	Date of environmental determination (ROD, FONSI, CE) or cite CE paragraph # (307-312) in Order 1050.1E, determination to accompany submittal			
	N/A	Date of land acquisition or signed purchase agreement			
	N/A	Snow removal equipment inventory & sizing worksheet (for SRE acquisition)			
	Attached	Apron sizing worksheet (for apron projects)			
	11/28/12	5010 Inspection Compliance (Attach copy of letter from Bureau of Aviation Safety)			
	N/A	Revenue producing facilities (for fuel farms, hangars, etc.)			

I certify to the best of my belief and knowledge that all runway approaches are clear of obstructions.

Sponsor's Signature: *Ben H. Jerness* Date: 4/20/15
 Printed Name: Ben H. Jerness Title: Chm, Edgar Co. Bd.
 Phone Number: 217-466-7433

Division of Aeronautics use only

Preapp Number	Grant Number	NPIAS Code	Work Code	FAA Priority	Federal \$



Illinois Department of Transportation
Division of Aeronautics

DETAILED PROJECT JUSTIFICATION / DESCRIPTION

AIRPORT NAME: Edgar County Airport

ASSOCIATED CITY: Paris, Illinois

PROJECT TITLE:
West Apron Expansion

PROJECT DESCRIPTION:
Expand the apron to the west.

DETAILED PROJECT JUSTIFICATION/ DESCRIPTION:
See attached letter for project description and justification discussion.



Illinois Department of Transportation
Division of Aeronautics

2016 TRANSPORTATION IMPROVEMENT PROGRAM
ESTIMATE OF WORK

Airport Name:	Edgar County Airport		
Associated City:	Paris		
Year Requested:	ANY	Sponsor Priority:	2

PROJECT TITLE:
West Apron Expansion

Estimate of Work					Potential DBE	
ITEM	QUANTITY		UNIT PRICE	PRICE	\$	%
	#	Unit(s)	\$ / Unit			
EXCAVATION						
Clearing/Grubbing			/			
Earthwork	1200	CY	\$20.00 / CY	\$24,000.00		
DRAINAGE						
Underdrains			/			
Pipe			/			
Curb and Gutter			/			
Special Structures	2	EA	\$1,500.00 / EA	\$3,000.00		
PAVING						
Subbase Preparation	4100	SY	\$10.00 / SY	\$41,000.00		
209	955	TON	\$20.00 / TON	\$19,100.00		
501	4100	SY	\$75.00 / SY	\$307,500.00		
Seal Coat			/			
Crack Filling			/			
Bituminous Pavement Sawing			/			
Pavement Removal	700	SY	\$20.00 / SY	\$14,000.00		
Grooving			/			
Special (Pavement Preparation)	135	SY	\$65.00 / SY	\$8,775.00		
LIGHTING						
Fixtures, Signs (New/Relocated)	2	EA	\$850.00 / EA	\$1,700.00		
Cable & Transformers			/			
Regulators			/			
Vault Rehabilitation/Work		LS	/ LS			
Special/ ducts		LF	/ LF			
LANDSCAPING						
Seeding/Mulching/Blanket	1	AC	\$4,500.00 / AC	\$4,500.00	\$4,500.00	100.00%
Sodding			/			
Watering			/			
Special (Wetlands)			/			
FENCING						
Class C			/			
Class E			/			
Gates (Manual/Electric)			/			
OTHER / MISC.						
Marking	2150	SF	\$2.00 / SF	\$4,300.00	\$4,300.00	100.00%
Tiedown			/			
Other Specialty Items	1	LS	\$40,000.00 / LS	\$40,000.00		
Haul Route			/			
Erosion Control	1	LS	\$7,500.00 / LS	\$7,500.00		
Engineering/Contingency/Admin.	1	LS	\$111,125.00 / LS	\$111,125.00		
Studies (EIS, Drainage, M.P.)	1	LS	\$11,500.00 / LS	\$11,500.00		
Land Acquisition			/			

TOTAL COST:	Potential DBE:	
\$598,000.00	\$8,800.00	1.47%



Airport:	Edgar County	LOCID:	PRG	Local Priority:	3
Project Description:	Expand Apron to the East				FY 2016
Sketch: If not enough space provided below, please attach sketch.					
					
Justification:	See attached IDOT Form "Detailed Project Justification/Description"				
Cost Estimate: (Attach detailed cost estimate)					
Federal (90 %)	\$148,500	State (5 %)	\$8,250	Local (5 %)	\$8,250
				Total:	\$165,000
Sponsor Verification	Date: (see instruction sheet)				
For each and every project as applicable	6/25/07	Date of approved ALP with project drawn			
	1/28/09	Date of environmental determination (ROD, FONSI, CE) or cite CE paragraph # (307-312) in Order 1050.1E, determination to accompany submittal			
	N/A	Date of land acquisition or signed purchase agreement			
	N/A	Snow removal equipment inventory & sizing worksheet (for SRE acquisition)			
	Attached	Apron sizing worksheet (for apron projects)			
	11/28/12	5010 Inspection Compliance (Attach copy of letter from Bureau of Aviation Safety)			
	N/A	Revenue producing facilities (for fuel farms, hangars, etc.)			

I certify to the best of my belief and knowledge that all runway approaches are clear of obstructions.

Sponsor's Signature: Ben H. Jenness Date: 4/20/15
 Printed Name: Ben H. Jenness Title: Chair, Edgar Co. Bd.
 Phone Number: 217-466-7433

Division of Aeronautics use only

Preapp Number	Grant Number	NPIAS Code	Work Code	FAA Priority	Federal \$



Illinois Department of Transportation
Division of Aeronautics

DETAILED PROJECT JUSTIFICATION / DESCRIPTION

AIRPORT NAME: Edgar County Airport

ASSOCIATED CITY: Paris, Illinois

PROJECT TITLE:
East Apron Expansion

PROJECT DESCRIPTION:
Expand the apron to the east.

DETAILED PROJECT JUSTIFICATION/ DESCRIPTION:
See attached letter for project description and justification discussion.



Illinois Department of Transportation
Division of Aeronautics

2016 TRANSPORTATION IMPROVEMENT PROGRAM
ESTIMATE OF WORK

Airport Name:	Edgar County Airport		
Associated City:	Paris		
Year Requested:	ANY	Sponsor Priority:	3

PROJECT TITLE:
East Apron Expansion

Estimate of Work						
ITEM	QUANTITY		UNIT PRICE	PRICE	Potential DBE	
	#	Unit(s)	\$ / Unit		\$	%

EXCAVATION

Clearing/Grubbing			/			
Earthwork	410	CY	\$20.00 / CY	\$8,200.00		

DRAINAGE

Underdrains			/			
Pipe			/			
Curb and Gutter			/			
Special Structures	1	EA	\$1,500.00 / EA	\$1,500.00		

PAVING

Subbase Preparation	1210	SY	\$10.00 / SY	\$12,100.00		
209	575	TON	\$30.00 / TON	\$17,250.00		
401	350	TON	\$150.00 / TON	\$52,500.00		
Seal Coat			/			
Crack Filling			/			
Bituminous Pavement Sawing	245	LF	\$5.00 / LF	\$1,225.00		
Pavement Removal	50	SY	\$20.00 / SY	\$1,000.00		
Grooving			/			
Special (Pavement Preparation)	25	SY	\$65.00 / SY	\$1,625.00		

LIGHTING

Fixtures, Signs (New/Relocated)		EA	/ EA			
Cable & Transformers			/			
Regulators			/			
Vault Rehabilitation/Work		LS	/ LS			
Special/ ducts		LF	/ LF			

LANDSCAPING

Seeding/Mulching/Blanket	0.5	AC	\$4,500.00 / AC	\$2,250.00	\$2,250.00	100.00%
Sodding			/			
Watering			/			
Special (Wetlands)			/			

FENCING

Class C			/			
Class E			/			
Gates (Manual/Electric)			/			

OTHER / MISC.

Marking	120	SF	\$5.00 / SF	\$600.00	\$600.00	100.00%
Tiedown	9	EA	\$400.00 / EA	\$3,600.00	\$900.00	25.00%
Engineer's Field Office	1	LS	\$2,500.00 / LS	\$2,500.00		
Haul Route	1	LS	\$10,000.00 / LS	\$10,000.00		
Erosion Control	1	LS	\$2,550.00 / LS	\$2,550.00		
Engineering/Contingency/Admin.	1	LS	\$48,100.00 / LS	\$48,100.00		
Studies (EIS, Drainage, M.P.)			/			
Land Acquisition			/			

Potential DBE		
	\$	%
	\$165,000.00	2.27%



Illinois Department of Transportation

Division of Aeronautics

1 Langhorne Bond Drive / Springfield, Illinois / 62707-8416

November 28, 2012

Mr. Jimmy Wells, Manager
Edgar County Airport
15551 Airport Road
Paris, IL 61944

RE: State Annual & FAA 5010 Inspection
Edgar County Airport

Dear Mr. Wells:

An FAA 5010 and annual State inspection were conducted at your airport on November 18, 2012. The information obtained will reflect the current airport physical conditions and will be used to revise our database. The amended 5010 information will be forwarded to the Airport Safety Data Branch in Washington, DC for inclusion and revision, if any, of the Airport/Facility Directory.

As in previous years, the airport was neat and tidy and the area on both sides of the runway and taxiway area appeared to be on an adequate mowing schedule. The wind cones (wind sock) indicators at each end of the E/W runway give pilots 'real time' information regarding runway wind conditions. The 'hold short' markings were quite legible, and taxiway striping and runway centerline striping were in good condition.

The secondary purpose in visiting your airport was to examine and inspect the new and commissioned N/S runway and determine what, if any, are the controlling obstructions at either end of the runway. This information was obtained; however the reporting of such and incorporating the information into the 5010 inspection report will be delayed until the engineering data, now in the process of being assimilated, has been transmitted in the appropriate protocol for inclusion into the A/FD. When this occurs, an amended 5010 will be submitted in a timely manner, reflecting the added runway with the integrated controlling obstruction data obtained during this inspection.

It is suggested that herbicidal treatment be placed around the new runway light standards associated with the newly commissioned N/S runway, similar to the treatment already in place for the E/W runway.

Jimmy Wells
November 28, 2012
Page Two

Reiterating previous inspection letters, the data elements shown on the accompanying copy of the FAA 5010 preceded by a ">" symbol are considered critical safety items. It is the responsibility of the Airport Manager (or designated individual responsible) to report any subsequent changes of these items to the FSS immediately so that appropriate NOTAMS can be issued. This will assure that the most current safety information is available to the flying public.

A copy of your Based Aircraft Details Report is also enclosed. We have been asked to pass this along to the airport managers for review at the time of the 5010 Inspection. Please determine what corrections need to be made to your Based Aircraft List and log on at <http://www.basedaircraft.com/Login.aspx> to update your data.

Please feel free to contact our office if you have any questions regarding the above or the inspection of your airport in general.

Sincerely,



Linda K. Schumm
Bureau Chief Aviation Education and Safety

cc: FAA CHI-ADO
Bureau of Airport Engineering
Chris Patrick, Chairman, Airport Committee

U.S. DEPARTMENT OF TRANSPORTATION
FEDERAL AVIATION ADMINISTRATION

AIRPORT MASTER RECORD

PRINT DATE: 11/07/2012
AFD EFF: 09/20/2012
Form Approved OMB 2120-0015

> 1 ASSOC CITY: PARIS 4 STATE: IL LOC ID: PRG FAA SITE NR: 04931.41A
> 2 AIRPORT NAME: EDGAR COUNTY 5 COUNTY: EDGAR IL
> 3 CBD TO AIRPORT (NM): 05 N 6 REGION/ADO: AGL/CHI 7 SECT AERO CHT: ST LOUIS

GENERAL
> 10 OWNERSHIP: PU
> 11 OWNER: SUP BOARD OF EDGAR CO
> 12 ADDRESS: 15551 ARPT RD
PARIS, IL 61944-8474
> 13 PHONE NR: 217-486-4151
> 14 MANAGER: JIMMY WELLS
> 15 ADDRESS: 15551 ARPT RD
PARIS, IL 61944-8474
> 16 PHONE NR: 217-486-8474
> 17 ATTENDANCE SCHEDULE:
ALL MON-FRI 0800-1600
ALL SAT 0800-1400
ALL SUN ON CALL

SERVICES
> 70 FUEL: 100LL A
> 71 AIRFRAME RPRS:
> 72 PWR PLANT RPRS:
> 73 BOTTLE OXYGEN: NONE
> 74 BULK OXYGEN: NONE
75 TSNT STORAGE: HGR, TIE
75 OTHER SERVICES:

BASED AIRCRAFT
90 SINGLE ENG: 23
91 MULTI ENG: 4
92 JET: 0
TOTAL: 27
93 HELICOPTERS: 0
94 GLIDERS: 0
95 MILITARY: 0
96 ULTRA-LIGHT: 1

18 AIRPORT USE: PUBLIC
19 ARPT LAT: 38-42-00.5740N ESTIMATED
20 ARPT LONG: 087-40-10.6270W
21 ARPT ELEV: 654.0 SURVEYED
22 ACREAGE: 180
> 23 RIGHT TRAFFIC:
> 24 NON-COMM LANDING: NO
> 25 NPAS/FED AGREEMENTS:NGY
> 26 FAR 139 INDEX:

FACILITIES
> 80 ARPT BCN: CG
> 81 ARPT LGT SKED: SEE RMK
> 82 UNICOM: 123.000
> 83 WIND INDICATOR: YES-L
84 SEGMENTED CIRCLE: YES
85 CONTROL TWR: NONE
86 FSS: SAINT LOUIS
87 FSS ON ARPT: NO
88 FSS PHONE NR:
89 TOLL FREE NR: 1-800-WX-BRIEF

OPERATIONS
100 AIR CARRIER: 0
102 AIR TAXI: 150
103 G A LOCAL: 3,350
104 G A TRNTY: 3,500
105 MILITARY: 0
TOTAL: 7,000
OPERATIONS FOR 12 MONTHS ENDING 09/30/2012
10/31/2012

RUNWAY DATA

> 30 RUNWAY DENT:
> 31 LENGTH:
> 32 WIDTH:
> 33 SURF TYPE-COND:
> 34 SURF TREATMENT:
35 GROSS WT: SW
36 (IN THSDS) DW
37 DTW
38 DDTW
> 39 PCN:

09/27			
4,502			
75			
ASPH-F			
12.5			
MED			
NPI - G / NPI - G	- / -	- / -	- / -
PSIL / PSIL	/ /	/ /	/ /
25 / 25	/ /	/ /	/ /
3.00 / 3.00	/ /	/ /	/ /
N - N / N - N	- / -	- / -	- / -
- N / - N	- / -	- / -	- / -
N / Y	/ /	/ /	/ /
M / M	/ /	/ /	/ /
A(NP) / A(NP)	/ /	/ /	/ /
TREE / TREE	/ /	/ /	/ /
38 / 89	/ /	/ /	/ /
1,411 / 1,787	/ /	/ /	/ /
104L / 131L	/ /	/ /	/ /
31:1 / 29:1	/ /	/ /	/ /
N / N	/ /	/ /	/ /
/	/	/	/
/	/	/	/
/	/	/	/
/	/	/	/

LIGHTING/APCH AIDS

> 40 EDGE INTENSITY:
> 42 RWY MARK TYPE-COND:
> 43 VGS:
44 THR CROSSING HGT:
45 VISUAL GLIDE ANGLE:
> 46 CNTRLN-TDZ:
> 47 RVR-RVY:
> 48 REL:
> 49 APCH LIGHTS:

OBSTRUCTION DATA

50 FAR 77 CATEGORY:
> 51 DISPLACED THR:
> 52 CTLG OBSTN:
> 53 OBSTN MARKED/LGTD:
> 54 HGT ABOVE RWY END:
> 55 DIST FROM RWY END:
> 56 CNTRLN OFFSET:
> 57 OBSTN CLNC SLOPE:
> 58 CLOSE-IN OBSTN:

DECLARED DISTANCES

> 60 TAKE OFF RUN AVBL (TORA):
> 61 TAKE OFF DIST AVBL (TODA):
> 62 ACLT STOP DIST AVBL (ASDA):
> 63 LNDG DIST AVBL (LDA):

> 110 REMARKS:
A 043 RWY 09 UNUSBL BYD 5 DEG LEFT/RIGHT OF CNTRLN.
A 043 RWY 27 UNUSBL BYD 5 DEG LEFT/RIGHT OF CNTRLN.
A 081 RWY APT MRL RY 09/27 PRESET ON LOW INTST; TO INCR INTST & ACTVT PSIL RYS 09 & 27 - CTAF.
A 110 THIS AIRPORT HAS BEEN SURVEYED BY THE NATIONAL GEODETIC SURVEY.

Also NOTAMS indicate N/S 3200' hwy; as commissioned but survey data not complete

111 INSPECTOR: (S) 112 LAST INSP: 08/10/2010 11/01/2012 113 LAST INFO REQ:

PARIS, IL - EDGAR COUNTY - (PRG) SN: 04931.41A



REMARKS: 180 ACRES

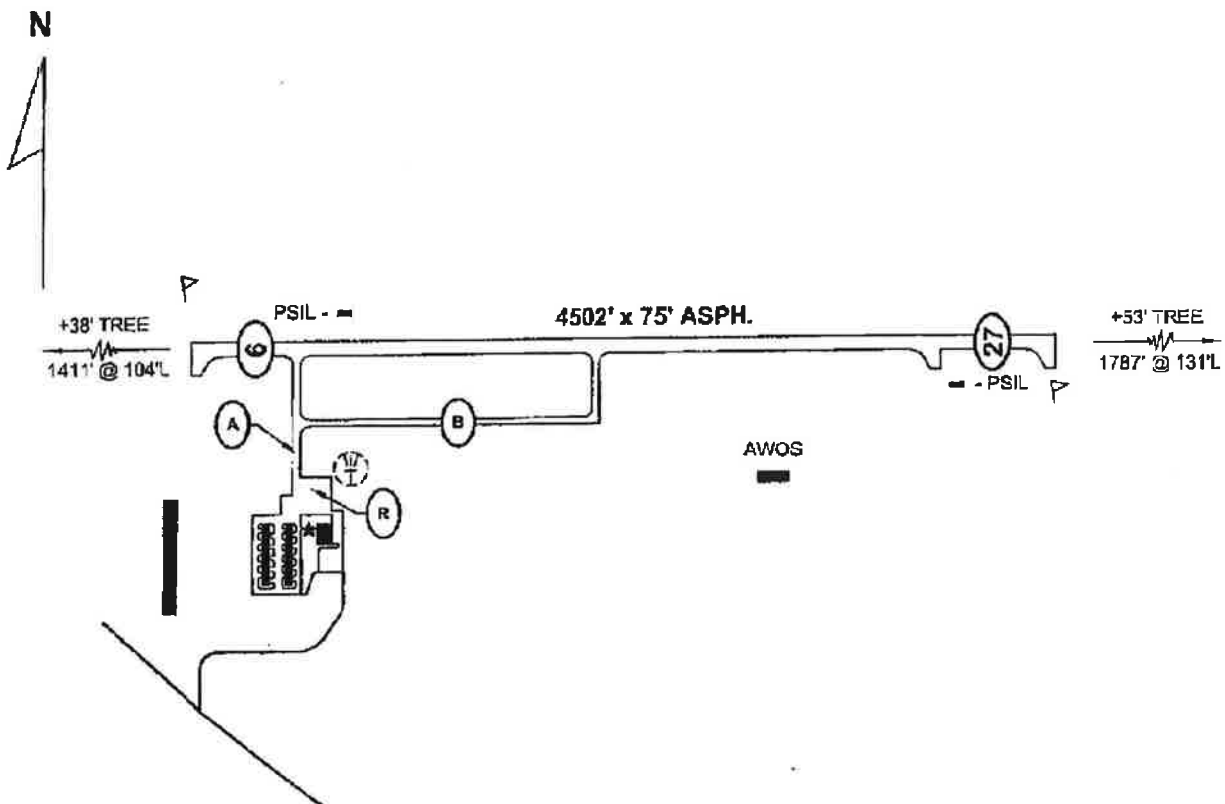

11/08/2012

NOT TO SCALE